

# CPRI 300

Conduction-cooled capacitor

Technology Patented Worldwide

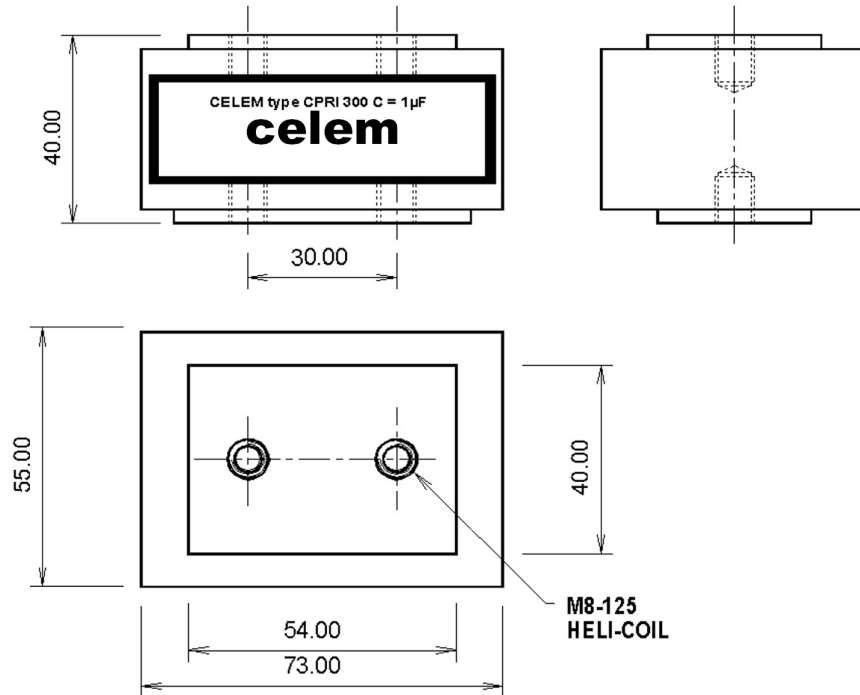

The CPRI 300 conduction-cooled capacitor, although still produced, has been superseded by the CPRI 400New.

## Specifications

TYPE		CPRI 300					
Dimensions (L x W x H)	mm	73 x 55 x 40					
Weight	kg	0.7					
Capacitance ( $\pm 10\%$ )	$\mu\text{F}$	0.1	0.4	0.67	0.8	1	1.25
Sinusoidal Voltage	$V_{rms}$	500					
Peak Voltage	$\hat{V}$	710					
Max. Current	$A_{rms}$	650					
Max. Power	$\text{kVA}_r$	300					

*Celem Power Capacitors*

Produced: March 17, 2009

# CPRI 300

Conduction-cooled capacitor

Technology Patented Worldwide

