

GENERAL TECHNICAL CHARACTERISTICS

Reference standards : IEC 61071-60068
 Dielectric : Polypropylene film
 Construction : Metallized film
 Coating : Aluminum case. Dry construction
 Leads : Threaded insert M5 M6, bolt available

ELECTRICAL CHARACTERISTICS

Operating temperature range : - 40 to + 85 °C (Hotspot temperature)
 Capacitance : 8 to 350µF
 Rated Voltage : 400 to 850VDC (250 to 450Vac)
 Tolerance : ± 5% , ± 10%
 Dissipation factor : $\leq 2 \times 10^{-3}$ Measured at 100Hz and 20±5 °C
 Life expectancy : 100,000 hours at Un and 70 °C
 30,000 hours at Urms and 70 °C
 (Hotspot temperature)

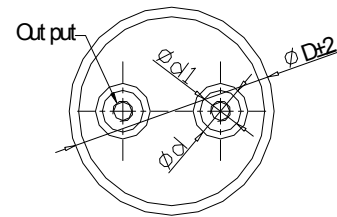
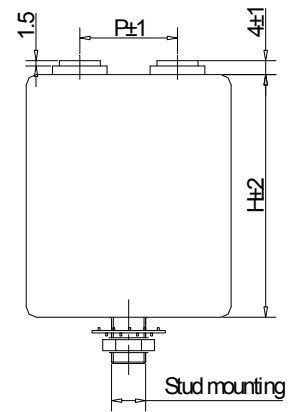

TEST METHODS AND PERFORMANCES

Dielectric strength: 1.5Un (DC) applied to 10s at 20±5°C
 Test voltage terminal to case : 3KVAC/50Hz for 60s
 Insulation resistance : ≥ 10000 s, after 1 minute of electrification
 at 100VDC (20±5 °C)

ORDERING CODE

Please refer to Page 10, item J

Case	Out put				Stud mounting		
	F	Torque	d	d1	P	S	Torque
D=55	M5×8	2.5N.M Max	17	14	22.0	M10×12	6.0N.M Max
D=60,65					28.6		
D=76,86	M6×8	8.5N.M Max	20	16	32.0	M12×16	8.0N.M Max

Electrical specifications, ordering codes

Ordering Code	Cap (µF)	D (mm)	H (mm)	P (mm)	Irms@45°C @10kHz (A)	ESR@1.0kHz (mΩ)	RTH (k/w)	Weight (kg)
Un 400VDC , Urms 250VAC , Upeak 360V , Us 600V								
SRD-400-30-FS	30	55	55	22.0	27	2.8	9.7	0.20
SRD-400-50-FS	50	60	70	22.0	29	3.0	8.1	0.23
SRD-400-60-FS	60	65	70	28.6	31	2.7	7.5	0.25
SRD-400-70-FS	70	76	70	28.6	34	2.5	6.8	0.30
SRD-400-100-FS	100	60	125	28.6	44	2.2	4.6	0.40
SRD-400-120-FS	120	65	125	28.6	47	2.0	4.3	0.45
SRD-400-130-FS	130	65	125	28.6	49	2.0	4.3	0.50
SRD-400-150-FS	150	76	125	32.0	53	1.9	3.7	0.75
SRD-400-200-FS	200	86	125	32.0	59	1.7	3.3	0.95
SRD-400-250-FS	250	76	180	32.0	68	1.6	2.6	1.00
SRD-400-350-FS	350	86	180	32.0	74	1.5	2.3	1.30
Un 600VDC , Urms 330VAC , Upeak 470V , Us 900V								
SRD-600-15-FS	15	55	55	22.0	24	3.5	9.7	0.20
SRD-600-25-FS	25	55	70	22.0	25	3.9	8.1	0.23
SRD-600-33-FS	33	60	70	28.6	29	3.3	7.5	0.25
SRD-600-40-FS	40	65	70	28.6	31	2.9	7.0	0.30
SRD-600-50-FS	50	60	125	22.0	40	2.6	4.6	0.45
SRD-600-65-FS	65	60	125	28.6	44	2.3	4.6	0.45
SRD-600-75-FS	75	65	125	28.6	47	2.2	4.3	0.50
SRD-600-100-FS	100	76	125	32.0	52	1.9	3.7	0.75
SRD-600-130-FS	130	86	125	32.0	58	1.8	3.3	0.95
SRD-600-150-FS	150	76	180	32.0	67	1.7	2.6	1.00
SRD-600-200-FS	200	86	180	32.0	73	1.7	2.3	1.30

Electrical specifications, ordering codes

Ordering Code	Cap (μ F)	D (mm)	H (mm)	P (mm)	I _{rms} @45°C @10kHz (A)	ESR@1.0kHz (m Ω)	RTH (k/w)	Weight (kg)
Un 700VDC , Urms 400VAC , Upeak 570V , Us 1050V								
SRD-700-12-FS	12	55	55	22.0	24	3.5	9.7	0.20
SRD-700-15-FS	15	55	70	22.0	23	4.8	8.1	0.23
SRD-700-20-FS	20	60	70	28.6	26	3.9	7.5	0.25
SRD-700-25-FS	25	65	70	28.6	29	3.4	7.0	0.30
SRD-700-33-FS	33	55	125	22.0	38	2.9	4.9	0.40
SRD-700-40-FS	40	60	125	28.6	41	2.6	4.6	0.45
SRD-700-50-FS	50	65	125	28.6	45	2.3	4.3	0.50
SRD-700-70-FS	70	76	125	32.0	51	2.0	3.7	0.75
SRD-700-90-FS	90	86	125	32.0	57	1.9	3.3	0.95
SRD-700-100-FS	100	76	180	32.0	65	1.8	2.6	1.00
SRD-700-130-FS	130	86	180	32.0	71	1.7	2.3	1.30
Un 850VDC , Urms 450VAC , Upeak 640V , Us 1275V								
SRD-850-8.0-FS	8.0	55	55	22.0	23	4.0	9.7	0.20
SRD-850-12-FS	12	55	70	22.0	23	4.9	8.1	0.23
SRD-850-15-FS	15	65	70	28.6	25	3.7	7.0	0.30
SRD-850-18-FS	18	65	70	28.6	28	3.7	7.0	0.30
SRD-850-22-FS	22	55	125	22.0	35	3.3	4.9	0.40
SRD-850-27-FS	27	60	125	28.6	39	2.9	4.6	0.45
SRD-850-33-FS	33	65	125	28.6	42	2.6	4.3	0.50
SRD-850-47-FS	47	76	125	32.0	49	2.2	3.7	0.75
SRD-850-60-FS	60	86	125	32.0	54	2.0	3.3	0.95
SRD-850-70-FS	70	76	180	32.0	63	1.9	2.6	1.00
SRD-850-90-FS	90	86	180	32.0	69	1.8	2.3	1.30